

Live on Campus

2024-2025



Cal Poly
Humboldt.

Live on Campus

Living on campus can be a highlight of your Cal Poly Humboldt experience. It’s a great way to meet friends and get connected with everything Humboldt has to offer. To get started and help make the decisions that are right for you and your family, here are some details about housing for 2024–25:

- **Application Process**
- **Important Dates & Deadlines**
- **Room & Meal Plan Costs**
- **On–Campus Meal Plans**
- **Housing Options**
- **Theme Housing**

Contact us if you have any questions at **707.826.3451** or **housing@humboldt.edu**. Can’t wait to see you on campus!

Application Process

Before you apply for housing, it’s important to remember that **on–campus housing is not guaranteed** and that waitlists are common. Housing assignments are done on a first–come, first–served basis for new students based on the date the application was electronically signed and completed.

When To Apply:

The academic year application is available mid–February and the application for spring semester housing is available in October. Students must accept admission to Cal Poly Humboldt to get access to the housing application.

Who Can Apply:

All newly admitted, provisionally admitted, and continuing Humboldt students can complete the online Housing & Residence Life application. Students must accept admission to Cal Poly Humboldt to get access to the housing application. First–Year Students are not required to live on campus but it is highly recommended.

How To Apply:

Go to your **myhousing portal** at **myhousing.humboldt.edu**, and log in with your Humboldt user name and password. Select your preferred living areas, meal plan and sign the license agreement, and submit the application. A \$100 nonrefundable application fee is due at signing.



Important Dates

Tuesday, Feb. 6 – Thursday, Feb. 22: Online Housing Application Opens

- **Tuesday, Feb. 6 at 11 a.m.**—Newly admitted and provisionally admitted students that have accepted their admission can preview the Housing Application.
- **Tuesday, Feb. 20 at 3 p.m.**—Application officially opens for First–Year Students to submit their Housing Application and pay the \$100 nonrefundable application fee.
- **Wednesday, Feb. 21 at 9 a.m.**—Application officially opens for Transfers to submit their Housing Application and pay the \$100 nonrefundable application fee.
- **Thursday, Feb. 22 at 9 a.m.**—Application officially opens for Continuing Students to submit their Housing Application and pay the \$100 nonrefundable application fee.

Monday, April 1: Priority Deadline for Housing Assignments

Those submitting an application by this date will be guaranteed a room or be put on a waitlist.

Monday, May 6: Notification of Assignment Status

Room assignments, guarantees of assignment, or waitlist notifications will be emailed to students who submitted the application by the April 1 Priority Deadline.

June: Notification of Assignment Status

Students who submit their application after the April 1 Priority Deadline will receive an email notification in June with a room assignment, guarantee of a space, or waitlist number.

Friday, July 19: Last Day to Cancel Housing Agreement

Students who wish to cancel their request to live on campus must notify the Housing Office by canceling through their **myHousing** portal or by email of this decision by July 19, 2024. Notifying any other university office does not satisfy your obligation to notify Housing & Residence Life. Such requests that are received by July 19 will be honored; all cancellations will forfeit the nonrefundable application fee of \$100.

Cancel On or After July 20

Beginning July 20, 2024, requests to cancel will be honored; however, these requests will forfeit the \$100 nonrefundable application fee, be charged a \$200 cancellation fee and charged a prorated daily penalty fee for each day of notice that is less than the required 30 days.

Saturday, Aug. 17: First–Year Students Move In

First–Year Students move in early to prepare for orientation programs.

Monday, Aug. 19: Transfer & Continuing Students Move–In

Check–in times will be assigned to all residents in order to help manage lines, minimize wait times, and provide you with the best service possible. For more information about Move In go to **housing.humboldt.edu/resident–resources/moving–in**.

Friday, Aug. 23: Room & Meal Plan Fees Due

Room & Meal Plan Rates

Residence Hall	Room Type	Room Rent Only	Room + All Access 7 Day	Room + All Access 5 Day	Room + Lumberjack 125	Room + Lumberjack 75
Meal Plans Required			\$6,116	\$5,464	\$3,824	\$2,298
The Hill, Canyon, Creekview Suites	Single	\$9,060	\$15,176	\$14,524	N/A	N/A
	Double	\$7,322	\$13,438	\$12,786	N/A	N/A
	Triple	\$5,444	\$11,560	\$10,908	N/A	N/A
Creekview Apartments	Single	\$9,472	\$15,588	\$14,936	\$13,296	\$11,770
	Double	\$7,654	\$13,770	\$13,118	\$11,478	\$9,952
Cypress	Single	\$9,060	\$15,176	\$14,524	\$12,884	\$11,358
	Double	\$7,322	\$13,438	\$12,786	\$11,146	\$9,620
Meal Plans Optional						
Campus Apartments	Single	\$9,060	\$15,176	\$14,524	\$12,884	\$11,358
	Double	\$7,322	\$13,438	\$12,786	\$11,146	\$9,620
College Creek Apartments	Single	\$9,576	\$15,692	\$15,040	\$13,400	\$11,874
	Double	\$7,728	\$13,844	\$13,192	\$11,552	\$10,026
	Double Bunk Bed	\$7,444	\$13,560	\$12,908	\$11,268	\$9,742
Off–Campus Hotels	Single	\$8,606	\$14,722	\$14,070	\$12,430	\$10,904
	Double	\$6,956	\$13,072	\$12,420	\$10,780	\$9,254

The table above provides the combined room and meal plan price for each meal plan and room type. Rates are projected, not confirmed, pending SFAC (Student Fee Advisory Committee) approval. Costs are for the academic year fee period, Fall 2024 – Spring 2025.

On–Campus Meal Plans

There are 4 meal plans offered for on–campus residents for 2024–2025.

All living areas require a meal plan except College Creek and Campus Apartments. Residents of the Hill, Canyon, and Creekview Suites are required to have one of the All Access meal plans. Residents of Creekview Apartments and Cypress are required to have any one of the meal plans. Each plan is designed primarily for meals in The J Dining Hall. However, each plan has Flex Dollars, as well as Meal Exchanges that can be used at any dining location. Each plan also has meals that can be used for resident’s guests in The J.

Meal Plan	Description	Flex Dollars	Guest Meals per semester	Meal Exchanges per semester	AY Cost	Semester cost
All Access 7 Day	The All Access 7 Day meal plan provides unlimited meals, 7 days a week in The J, and provides the best value of the meal plans. In addition, this plan gives students \$350 flex dollars per semester that can be used at any dining location. Also included are 71 meal exchanges that can be used at any dining location. One of the All Access meal plans are required for all residents of the Hill, Canyon and Creekview Suites. This plan has the best value for students that plan to eat on–campus everyday.	\$350	5	71	\$6,116	\$3,058
All Access 5 Day	The All Access 5 Day meal plan provides unlimited meals, 5 days a week, Monday – Friday only, in The J. In addition, this plan gives students \$250 flex dollars per semester that can be used at any dining location or to be used on the weekends. Also included are 53 meal exchanges that can be used Monday – Friday at any dining locations. One of the All Access meal plans are required for all residents of the Hill, Canyon and Creekview Suites. This plan is best suited for students that do not plan on eating at on–campus dining locations most weekends.	\$250	4	53	\$5,464	\$2,732
Lumberjack 125	The Lumberjack 125 meal plan provides 125 meals. This plan includes 107 swipes that can be used in The J and 18 meal exchanges that can be used at any dining location. In addition, this plan gives students \$500 flex dollars per semester that can be used at any dining location.	\$500	3	18	\$3,824	\$1,912
Lumberjack 75	The Lumberjack 75 meal plan provides 75 meals. This plan includes 57 swipes that can be used in The J, and 18 meal exchanges that can be used at any dining location. In addition, this plan gives students \$250 flex dollars per semester that can be used at any Dining location.	\$250	2	18	\$2,298	\$1,150

Rates are projected, not confirmed, pending SFAC (Student Fee Advisory Committee) approval. Costs are for the academic year fee period, Fall 2024 – Spring 2025.

Residence Halls 2024–25

Where students live depends on their standing (First-Year Students or Upperclass). Here are descriptions of living options, which include the type of housing and rooms, and amenities. Go to housing.humboldt.edu/cost-options/options for more detailed information.

First-Year Students

The Hill (Redwood and Sunset halls)

Housing Type: Traditional residence halls. Each houses approximately 225 students. Some floors single gender, others all genders. Bathrooms are not all genders.

Room Type: Primarily double and triple rooms.

Amenities: Bed, dresser, desk, and closet for each resident (except in triple rooms—one resident has a wardrobe instead of a closet). Study area and a TV lounge. Kitchen, laundry, vending machines, ping pong tables in each building. Internet access.

Meal Plan: Required

Canyon (Alder, Cedar, Chinquapin, Hemlock, Madrone, Maple, Pepperwood, and Tan Oak halls)

Housing Type: Traditional residence halls. Approximately 50 students per building. Floors are single gender.

Room Types: Single, double, and triple rooms; bunk bed double with living room in 4-person suite.

Amenities: Bed, dresser, desk, and closet for each resident (except in triple rooms—one resident has a wardrobe instead of a closet). Kitchen, laundry room, and a TV/study lounge in each building. Internet access.

Meal Plan: Required

First-Year & Upperclass Students

Cypress

Housing Type: Suites. House about 230 students. 7-12 students per suite. Some single gender, others all genders.

Room Type: Single or double rooms.

Amenities: Bed, desk, and wardrobe closet for each resident. Common living room, bathroom, kitchen area with cooking facilities and dining table in each suite. Laundry facilities on ground floor and some suites. Internet access. Either patio or balcony.

Meal Plan: Required

The Hill

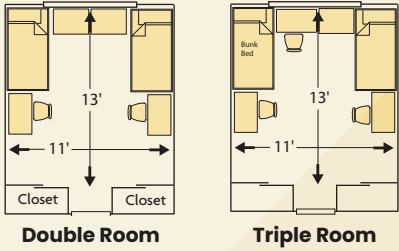

Canyon

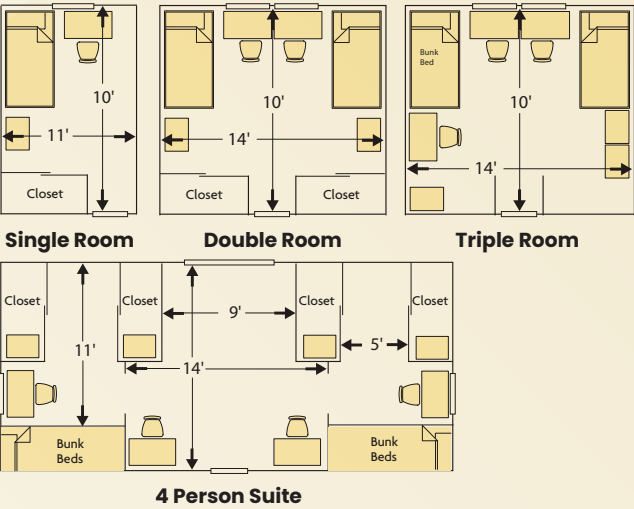

Cypress

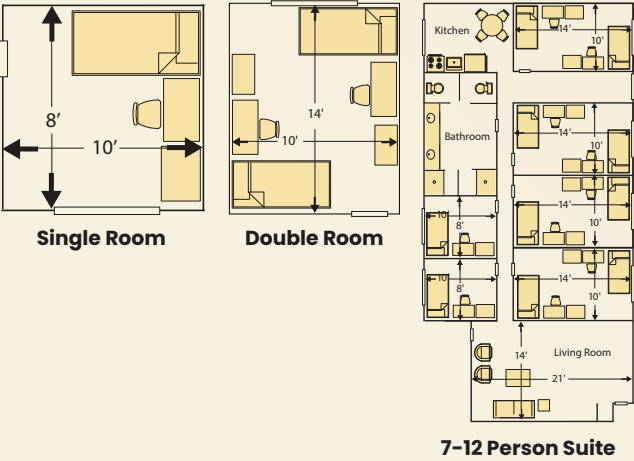

Upperclass Students

Creekview Apartments (Fern and Willow buildings)

Housing Type: Apartments. 5-6 students per apartment. Apartments are single gender or all genders; all rooms are single gender.

Room Type: Single and double rooms.

Amenities: Bedrooms furnished with a bed, dresser, and closet for each resident. Full kitchen, living room, dining area, and bathroom. Internet access.

Meal Plan: Required

Creekview Suites (Juniper and Laurel buildings)

Housing Type: Suites. 6 students per suite. Suites are single gender or all genders; all rooms are single gender.

Room Type: Single, double, and triple rooms.

Amenities: Bed, desk, dresser, and closet for each resident. Kitchenette, living room, dining area, and bathroom. Internet access.

Meal Plan: Required

College Creek (Del Norte, Shasta, Trinity, and Mendocino buildings)

Housing Type: Apartments. Houses 430 students. 4 – 6 students per apartment. Apartments are single gender or all genders; all rooms are single gender.

Room Type: Double, bunk bed double, and single rooms.

Amenities: Bed, desk, dresser, and closet for each resident. Full kitchen, living room, dining area, and bathroom. Internet access.

Meal Plan: Optional

Campus Apartments

Housing Type: Apartments. Home to 203 students. 2 rooms per apartment. Single gender or all genders.

Room Type: Primarily double rooms. Limited number of single rooms.

Amenities: Bed, desk, chair, and dresser for each resident. 1 bathroom per room. Shared kitchen. Internet access (WiFi only).

Meal Plan: Optional

Creekview

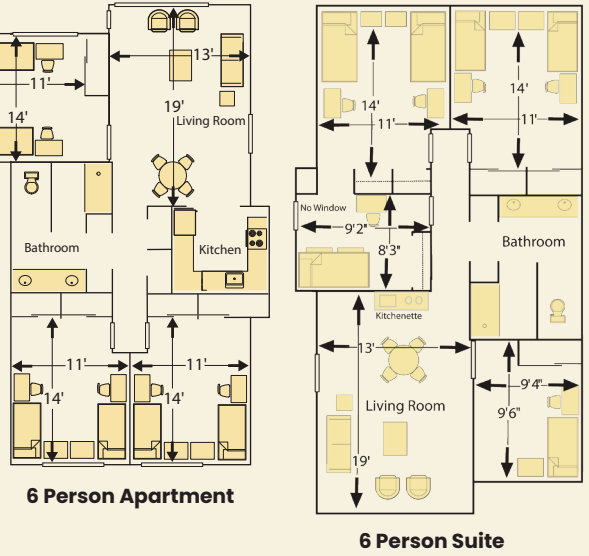
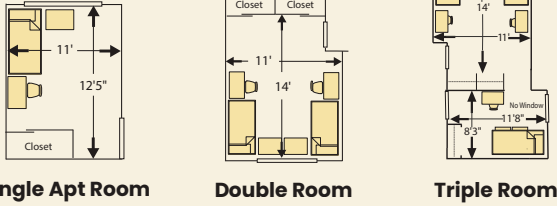

College Creek

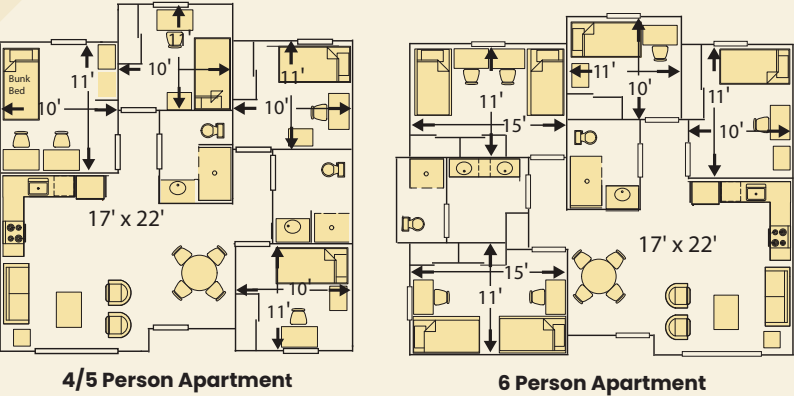
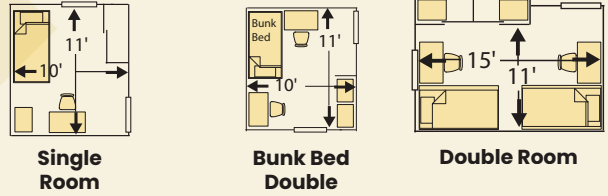

Campus Apartments

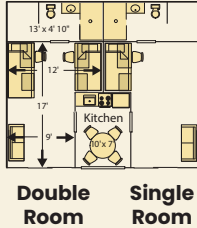

Dimensions may vary on floorplans.

Theme & Learning Community Housing 2024–25

Theme & Learning Community Housing living areas are organized around an academic, cultural, or personal interest. Please also note that certain living areas require an application, and if there is a lack of interest, prospective participants will be notified that community is no longer offered.

Among Giants

Students explore the biodiversity of coastal redwood forests and prairies—sampling microbes, identifying plants, and detecting cryptic mammals—and learn how the Wiyot and Yurok tribes have interacted with these species and ecosystems since time immemorial. For more information visit amonggiants.humboldt.edu.

Who’s Eligible: First-Year Biology, Botany, Zoology majors

Baduwa’t to Bay

Students will be introduced to engineering design within the Baduwa’t (Mad River) Watershed, and explore water quality, river restoration, renewable energy and other local design solutions addressing global issues. For more information visit baduwattobay.humboldt.edu.

Who’s Eligible: First-Year Energy Systems Engineering, Environmental Resources Engineering, and Mechanical Engineering majors

Creando Raíces

This community brings issues from students’ classes into every aspect of the real world. Each course builds and expands upon what you already know and believe—your roots—while deepening your appreciation and awareness of justice and liberation and gaining career development opportunities along the way. For more information visit raices.humboldt.edu.

Who’s Eligible: First-Year Kinesiology, Psychology, and Social Work majors

Creative Coast

This residence option introduces students to art resources on campus and in the wider Humboldt community including public art, galleries, museums, and local arts non-profits through field trips and hands-on learning opportunities. Students are offered guaranteed enrollment in studio art and art history classes. For more information visit creativecoast.humboldt.edu.

Who’s Eligible: First-Year Art Education, Art History, Film, and Studio Art majors

Educators for Social Justice

For students with an interest in learning about how issues of education and social justice today, can shape our futures tomorrow. All of our handpicked instructors believe in the same goal: making the schooling experience equitable and empowering for all students. For more information visit t4sj.humboldt.edu.

Who’s Eligible: First-Year Liberal Studies Elementary Education (LSEE) and Child Development majors

Global Humboldt

This “globally” the med learning community is for any first-year students who are still figuring out what their major will be. Residents will experience special programmatic activities focused on exploring the connections between our many local communities and the rest of the world while investigating academic major options and future career opportunities. For more information visit global.humboldt.edu.

Who’s Eligible: First-Year Undeclared students, based on application

Green to Gold

A cohort environment focused on the global green revolution that seeks to balance the needs of people, planet, and profits. Embark on an exciting adventure with classmates to create a more sustainable future and gain career development opportunities. For more information visit greentogold.humboldt.edu

Who’s Eligible: First-Year Business majors

Indoor Adventure

A community of casual and serious gamers from all academic disciplines who share a passion for video gaming, other gaming, anime, and comic books in a supportive community setting. Residents can network with various on-campus organizations, including the Committee on Resident Entertainment & Gaming (CORE-G).

Who’s Eligible: First-Year Students only

Klamath Connection

Students explore environmental and social justice issues associated with the region, including conflicts over water rights, natural resource conservation, and issues affecting Yurok and Karuk communities. For more information visit klamathconnection.humboldt.edu.

Who’s Eligible: First-Year Applied Fire Science & Management, Environmental Science & Management, Fisheries Biology, Forestry, Rangeland Resource Science, and Wildlife majors

La Comunidad

Designed for students who share an interest in regenerating cultural values, traditions, and customs rooted in the experiences, histories, and multidimensional identities of those who do and do not identify as Latinx. It’s also designed to be a space where students feel connected and supported in a community centered on the experiences and heritage of the Latinx people.

Who’s Eligible: Open to all students, based on application

Native American Living

Native American Living is a community of residents interested in an environment that affirms Native American culture, current issues, language, and history. Residents will have the opportunity to participate in local activities with local tribal communities and agencies to build a community that provides academic and personal support. Humboldt Native American staff members advise this special interest area.

Who’s Eligible: Open to all students, based on application

Outdoor Adventure & Recreation

A community geared toward students who have a passion for outdoor activities and leadership. Establish community and build friendships. Past adventure trips include sea kayaking and rock climbing.

Who’s Eligible: First-Year Students only

Rainbow/Gender Inclusive Community

A gender-inclusive living community that affirms the cultural experiences of lesbian, gay, bisexual, transgender, intersex, queer, non-identifying, and questioning residents, and their allies. Students are paired regardless of sex or gender identity.

Who’s Eligible: Open to all students, based on application

Representing Realities

Students explore a variety of concepts to help understand and represent the world around us and all of our different realities—and to use these to better solve problems. For more information visit representingrealities.humboldt.edu.

Who’s Eligible: First-Year Computer Science, Data Science, Geospatial Science & Technology, Mathematics, and Software Engineering major

Rising Tides

Students will compare both the cultures and marine life in Humboldt & Trinidad Bays. These two marine environments allow students to explore how the Wiyot Tribe and Trinidad Rancheria have interacted with these ecosystems alongside social and environmental policy in both areas. For more information visit risingtides.humboldt.edu.

Who’s Eligible: First-Year Marine Biology and Oceanography majors

Sankofa House

A space for students to feel connected and supported in a community centered on the experiences and heritage of Black/African people. It’s also for those who are interested in exploring Black culture, history, identity, and African diasporic intellectual traditions.

Who’s Eligible: Open to all students, based on application

Stars to Rocks

Students explore the interdisciplinary nature of their majors, and how they can not become an expert in one without understanding the others. Physics describes the forces acting in our universe, shaping the chemical reactions that form the geological matter of our planet. For more information visit starstorocks.humboldt.edu.

Who’s Eligible: First-Year Chemistry, Geology, Physical Science, Physics, and Physics–Astronomy major

Students for Violence Prevention

For students with an interest in building community, getting connected to violence prevention work on campus, and creating a more consent-centered community. It is designed to create supportive and compassionate spaces that centralize the importance of consent, respecting boundaries, supporting survivors, and looking out for one another. For more information visit svp.humboldt.edu.

Who’s Eligible: Open to First-Year Students, based on application





H.

Admissions Office

(866) 850-9556 • admissions.humboldt.edu

Housing & Residence Life

Cal Poly Humboldt
355 Granite Avenue
Arcata, California 95521-7914
(707) 826-3451
housing.humboldt.edu